

Specification of installation

In order to ensure safety use, please notice the following items:

- . Read and understand the whole Specification.
- . Suitable for the use of 220~240v and 50~60Hz.
- . Please wear gloves as installment and avoid rot on the surface of plating.
- . Must be installed on the fixed places and be checked annually.
- . Please turn off the lighting source by soft cloth as cleaning prohibited to use of rotted detergent.
- . Please connect with the local sales service centhr when there are any abnormality.

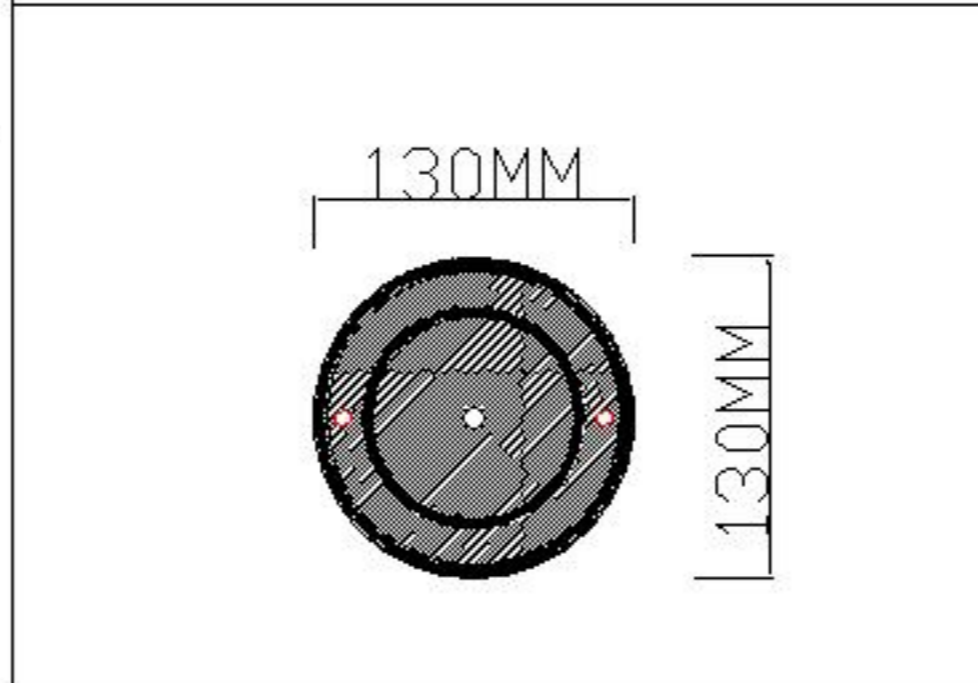
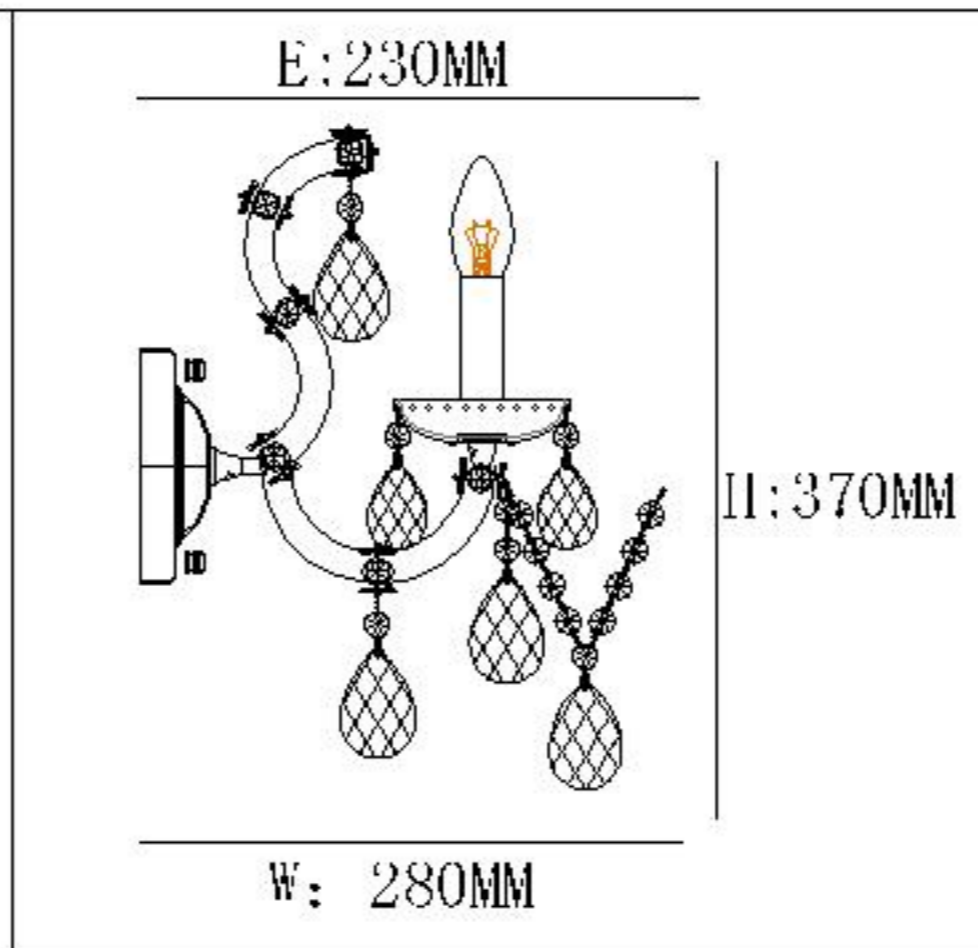
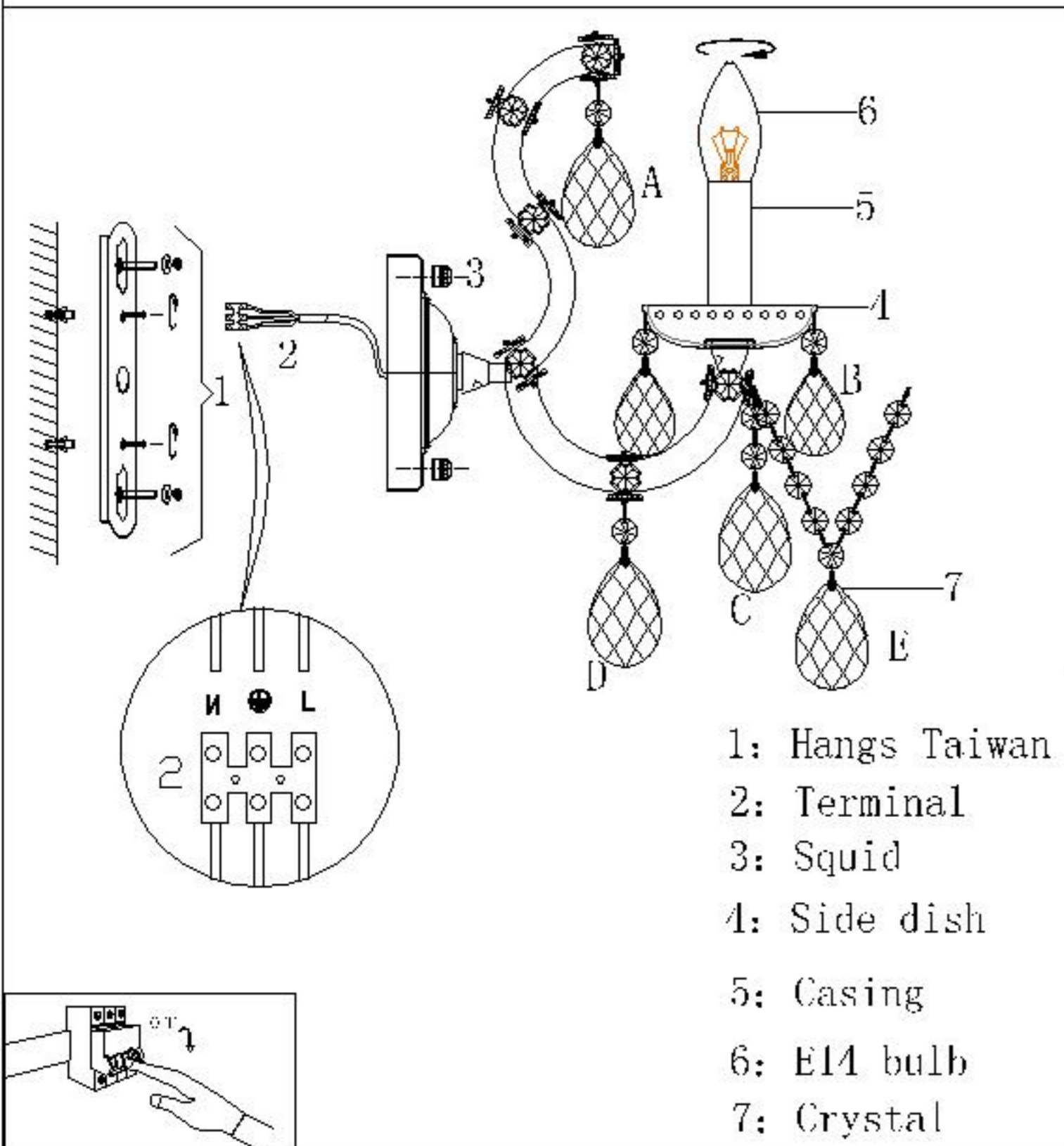

A		14#/1+2.5"	1PC
B		14#/1+2"	12PCS
C		14#/2+2.5"	2PCS
D		14#/1+2.5"	2PCS
E		14#/9+2.5"	1PCS

Product coding: ISABEL AP2 GOLD/TRANSPARENT